

drawing for customer information

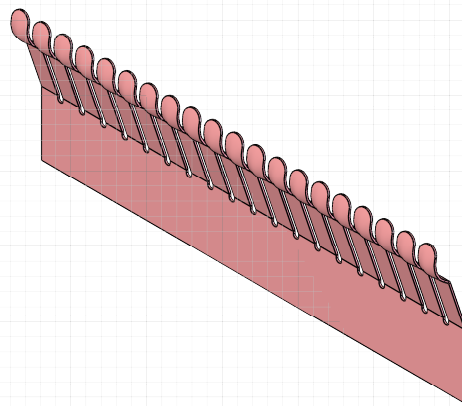

FEUERHERDT EMI Shielding Products Specialist for Contact Springs		tolerances: X,X ± 0,5 X,XX ± 0,2 X,XXX ± 0,1	length tolerance: 100-300 ± 0,5 300-400 ± 0,8 400-500 ± 1 > 500 ± 1,5	dimensions in mm unmeasured contours according to 3D data	scale: 2:1	revision: 00
				date: 04.06.20 name: Gutmann	material: rawmaterial: CuBe 2, 1/2H finalstate: CuBe 2, 1/2HT	
				checked: 22.06.20 name: Pröhl	description: <h1>type N1</h1>	
				released:	drawing number: <h1>CS.014.00.C</h1>	
				surface code: bright finish -02 gold -03 silver -04	sheet: A4	
				thickness: t= 0,15	replacement drawing:	
rev.	description	date	name			

Stripes can be cut off after each finger on request.
 Calculation of length in mm:
 strip length = number of fingers x 1 pitch - 1 slot



A

B

C

D

1

2

3

4

5

6

1

2

3

4

5

6