

A

B

C

D

A

B

C

D

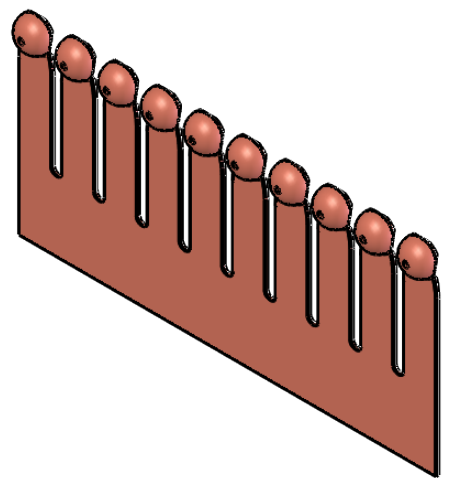
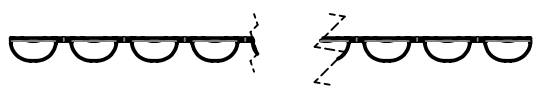
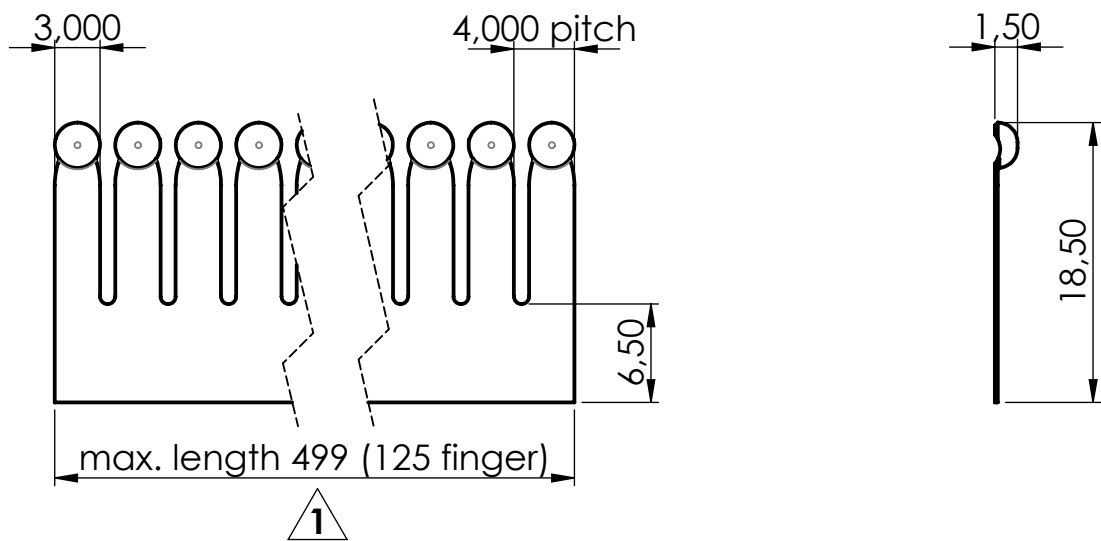

**drawing for customer information**

1

Stripes can be cut off after each finger on request.  
 Calculation of length in mm:  
 strip length = number of fingers x 1 pitch - 1 slot

|   |             |   |   |  |  |                     |
|---|-------------|---|---|--|--|---------------------|
| <b>FEUERHERDT</b><br>EMI Shielding Products<br>Specialist for Contact Springs |             | tolerances:<br>X,X ± 0,5<br>X,XX ± 0,2<br>X,XXX ± 0,1 | length tolerance:<br>100-300 ± 0,5<br>300-400 ± 0,8<br>400-500 ± 1<br>> 500 ± 1,5 | dimensions in mm<br>unmeasured contours according to 3D data | scale: <b>2:1</b>  | revision: <b>00</b> |
|   |             |   |   | date: 19.05.20<br>name: <b>Gutmann</b>                       | material: <b>rawmaterial: CuBe 2, 1/2H</b><br><b>finalstate: CuBe 2, 1/2HT</b> |                     |
|   |             |   |   | checked: 03.06.20<br>name: <b>Pröhl</b>                      | description:<br><h1>type B</h1>  |                     |
|   |             |   |   | released:  |  |                     |
|   |             |   |   | surface code:<br>bright finish -02<br>gold -03<br>silver -04 | drawing number:<br><h1>CS.002.00.C</h1>  |                     |
|   |             |   |   | thickness: t= 0,2  | sheet: 1   |                     |
| rev.  | description | date  | name  | replacement drawing:   |  |                     |

1

2

3

4

5

6